

LEANING COAXIAL THREE-WAY – TR9

Description:

Leaning coaxial three-ways are terminated with frames made of profiles and are additionally reinforced with transverse sheet corrugation. The leaning coaxial three-way features a circular branch at an angle depending on the side wall angle and reduction of the main duct.

Characteristics:

Measurement: DIN 18379

Sheet type: galvanized

Connection method: seam lock, spot weld

Standard design: x = 30mm, y = 30 mm, h = 100 mm

Endings: male-sized, P20, P20 LR, P30, P30 LR, bare end, outward bendings

Leakproofness standard: Class A, Class B, Class C

Stiffeners: available in larger dimensions

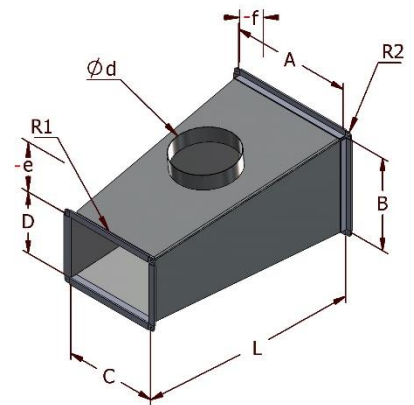
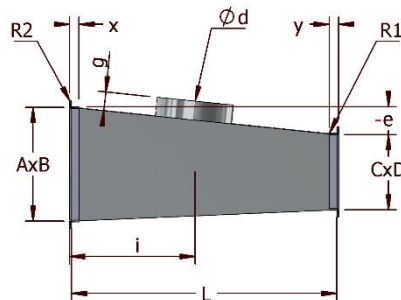
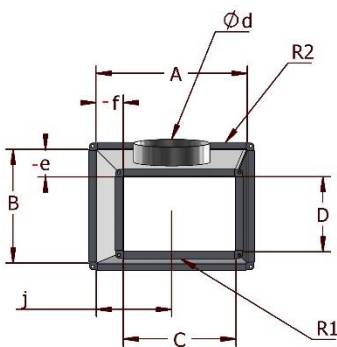

Sample manufactured element dimensions:

A (mm)	B (mm)	C (mm)	D (mm)	L (mm)	Ød (mm)	e (mm)	f (mm)	Area (m ²)
500	500	400	400	500	315	-50	-50	1.00
600	600	400	400	500	315	-100	-100	1.22
600	400	400	400	700	315	0	-100	1.41
800	800	600	600	700	450	0	0	2.33
1000	800	1000	600	1000	630	0	0	3.67
1200	800	1000	800	1000	630	0	-100	4.02